

The Built for long trouble-free life, the small and handy Grundfos jet pump is suitable for a wide variety of water supply and transfer duties in home, garden and hobby applications as well as in agriculture, horticulture and small-scale service industries.

The JP pump is a self-priming, single-stage centrifugal pump with axial suction port and radial discharge port, G 1 or Rp 1. The pump has a built-in ejector with guide vanes for optimum self-priming properties, and is directly coupled to a special fan cooled asynchronous Grundfos motor, adapted to the pump performance with an in-built protection switch. Grundfos PM1 manager can be supplied as an option.



System Operating

Operating pressure : Maximum 6bar

Suction Lift : Maximum 8 meters, including suction pipe pressure loss a liquid temperature of -20°C. 0°C to + 40°C.

Ambient temperature : Maximum +40°C

Enclosure class : IP 44(splash proof)

Insulation class : F

PUMPED LIQUIDS

Clean, thin, non-aggressive and non-explosive liquids without solid particles or bres.

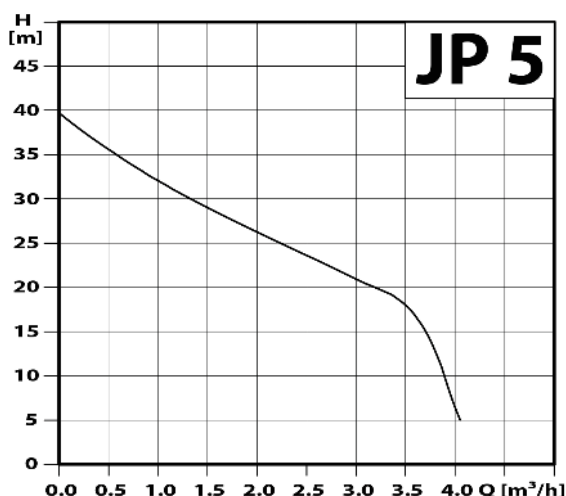
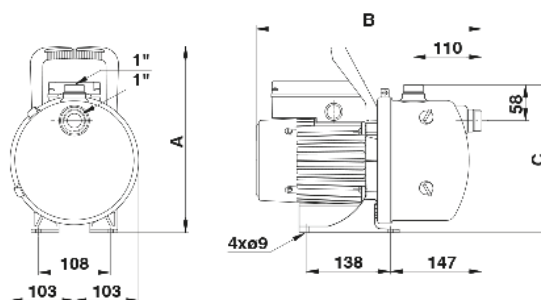

Pump type	P1 [W]	n [min ⁻¹]	Cos φ	In [A]	$\frac{I_{st}}{I_{1/1}}$	Dimensions [mm]		
						A	B	C
JP5 1 x 220-230Vtype	775	2650	0.99	3.7	3.5	300	364	240